

This is a general drawing. Additional parts, if required, like protection sheets, inspection covers, etc. are not displayed.

Designed constructed and stamped in accordance with 2004 ASME Code and latest Addendum.

PRESSURE PLATE

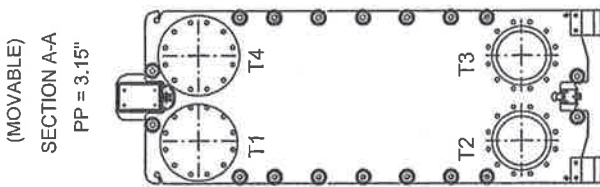

ASME 150 14"
SS
METAL LINING
T1, T2, T3, T4

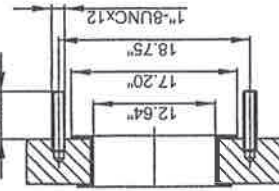

FRAME PLATE

(FIXED)

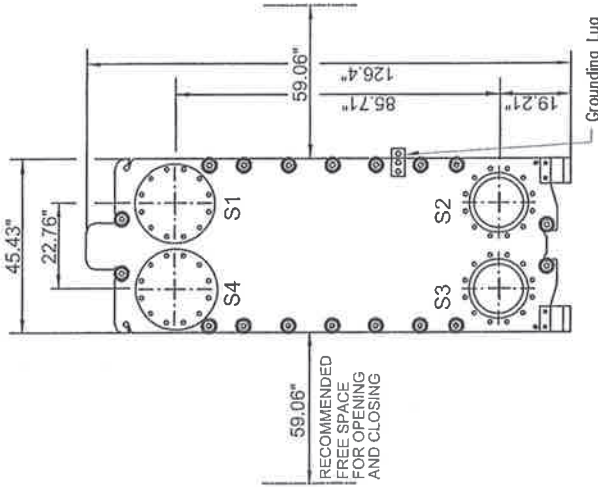

ASME 150 14"
SS
METAL LINING
S1, S2, S3, S4

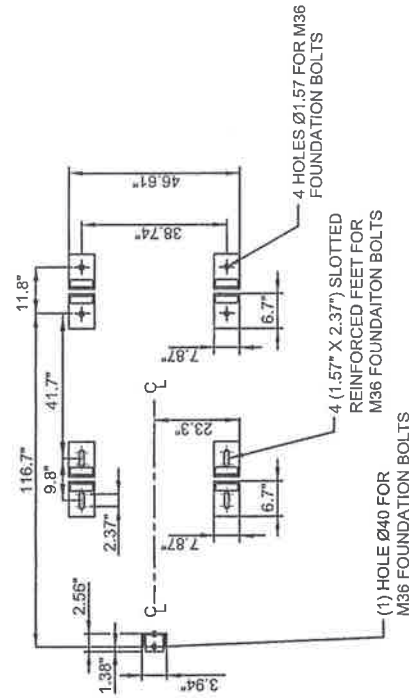
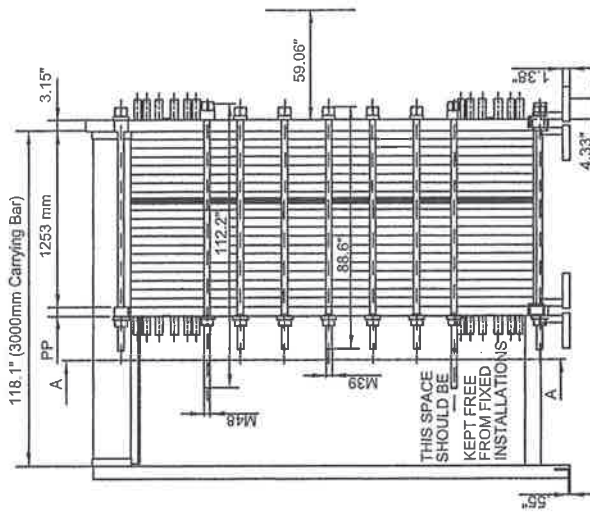
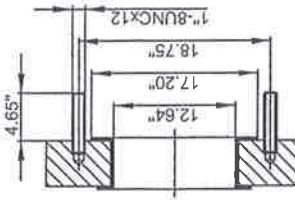

NOTE: (1) STAINLESS STEEL PARTITION PLATE.

REMARKS	SIDE1	SIDE2	GASKET	NBRP CLIP-ON
DESIGN PRESSURE	100 psig	100 psig	PLATE MATERIAL	ALLOY 316
TEST PRESSURE	130 psig	130 psig	PLATE THICKNESS	0.60 mm
MAX TEMPERATURE	200 °F	200 °F	HEATING SURFACE	3116 ft²
MIN TEMPERATURE	32 °F	32 °F	PLATE GROUPING	2*38A11/2*38B05
MAWP	100 psig	100 psig	OPERATING WEIGHT	19509 lb
MDMT	-20 °F		NETWEIGHT	14198 lb

TOTAL LENGTH 131.6"
TOTAL WIDTH 46.61"
TOTAL HEIGHT 126.4"

REV 4: ADDED REINFORCED FEET. ALL DIMENSIONS IN INCHES. TOLERANCE: +/- .25 INCH

SIDE	MEDIA	INLET	TEMP.	OUTLET	TEMP.	FLOW RATE	PRESSURE DROP	LIQUID VOL.
1	Beer Mash E-3104	S2	95.0 °F	T2	85.0 °F	1548000 lb/h	7.350 psi	59.9 ft³
2	Water	T3	70.0 °F	S3	85.0 °F	917200 lb/h	6.486 psi	26 ft³

SUPPLIER	REF. 6714-70	ITEM NO: E-3105
AGENT/REF.	FERMENTER CLR #2	
Alfa Laval Inc. / 649058		
CUSTOMER NAME / REF. NO.		
Delta T / 4500129967 //BUNGE ERGON VICKSBURG		
SIGN. PSS	RISKCATEGORY	N/A

PLATE HEAT EXCHANGER

WideGap350S-FG
ASME

SERIAL NO. 30110-68349	
DATE 2007-07-11	REV No. 4

**Alfa Laval, Plate Heat Exchanger
Channel Plate Installation Description**

2007-02-06

Customer:	Delta T	SU Order No:	6714-70
Model :	WideGap350S-FG	Serial No:	30110-68349
Customer PO:	4500129967	Item No:	E-3105

Plate material and Thickness:	ALLOY 316	0.60 mm
A Dimension:	1253 mm	
Grouping:	Hot side 2*38A11	Cold side 2*38B05
Sealing material:	NBRP CLIP-ON	NBRP CLIP-ON
Port Locations:	S2 -> T2	T3 -> S3
Connection material:	Stainless steel	Stainless steel
Inspection Cover	S1, S4, T1, T4	
Port hole with flow on the gasketed side:	U	
Port hole sealed with O-ring:	O	

Plates are assembled with the gasket side facing the frame plate.

Plate no.	Plate code no.	Plate Pattern		Punched corner of the plate				Flow direction on the gasket side of the plate
				upper left	lower left	lower right	upper right	
				S1	S2	S3	S4	
				= =	=>=	=>=	= =	
1	39506006 83	TL35 S1V	A	O	O	O	O	
2	39506005 03	TL35 S1R	B	U --<---	U	O	O	Up
3	39506006 03	TL35 S1V	A	O	O	U --<---	U	Down
4	39506005 03	TL35 S1R	B	U --<---	U	O	O	Up
5	39506006 03	TL35 S1V	A	O	O	U --<---	U	Down
6,	8,, 70	39506005 03	TL35 S1R	B				
7,	9,, 71	39506006 03	TL35 S1V	A				
72	39506005 03	TL35 S1R	B	U --<---	U	O	O	Up
73	39506006 03	TL35 S1V	A	O	O	U --<---	U	Down
74	39506005 03	TL35 S1R	B	U --<---	U	O	O	Up
75	39506006 03	TL35 S1V	A	O	O	U --<---	U	Down
76	39506005 03	TL35 S1R	B	U --<---	U	O	O	Up
77	39506006 64	TL35 S1V	A	O		--<---	U	Down
		PARTITION PLATE		O			O	
78	39506006 84	TL35 S1V	A	O			O	
79	39506005 03	TL35 S1R	B	U --->--	U	O	O	Down
80	39506006 03	TL35 S1V	A	O	O	U --->--	U	Up
81	39506005 03	TL35 S1R	B	U --->--	U	O	O	Down
82	39506006 03	TL35 S1V	A	O	O	U --->--	U	Up
83,	85,, 147	39506005 03	TL35 S1R	B				
84,	86,, 148	39506006 03	TL35 S1V	A				
149	39506005 03	TL35 S1R	B	U --->--	U	O	O	Down
150	39506006 03	TL35 S1V	A	O	O	U --->--	U	Up
151	39506005 03	TL35 S1R	B	U --->--	U	O	O	Down
152	39506006 03	TL35 S1V	A	O	O	U --->--	U	Up

153	39506005 03	TL35 S1R	B	U	--->--	U	O		O	Down
154	39506006 63	TL35 S1V	A	O		O	U	--->--	U	Up
		PRESSURE PLATE		= =		=<=	=<=		= =	
				T1		T2	T3		T4	

Article No:	Quantity:
39506006 83	1
39506005 03	76
39506006 03	74
39506006 64	1
39506006 84	1
39506006 63	1
	<hr/>
	154



Alfa Laval Plate Heat Exchanger Specification

Customer : Delta-T Corp.
Project : Bunge Ergon Vicksburg, LLC - Vicksburg, MS
Model : Widegap 350S-FG
PO. : 4500129967
Serial No. : 30110-68349
Item : E-3105 Fermenter Cooler #2 **Date:** 9/10/2007

		<u>Hot side</u>	<u>Cold side</u>
Fluid		Beer Mash	Water
Mass flow rate	lb/h	1548000	917200
Inlet temperature	°F	95.0	70.0
Outlet temperature	°F	85.0	85.0
Pressure drop	psi	7.35	6.49
Density	lb/ft ³	60.69	62.16
Specific heat capacity	Btu/lb, °F	0.89	1.00
Thermal conductivity	Btu/ft, h, °F	0.330	0.353
Viscosity inlet	cP	25.0	0.981
Viscosity outlet	cP	25.0	0.810
Heat exchanged	kBtu/h	13780	
L.M.T.D.	°F	12.3	
Heat transfer area	ft ²	3116	
Rel. directions of fluids			Countercurrent
Number of plates		153	
Number of passes		2	2
Plate material		ALLOY 316	
Sealing material		NBRP	NBRP
Connection material		Stainless steel	Stainless steel
Connection standard		14"	14"
Pressure vessel code		ASME Sect VIII latest Addendum	
Design pressure	psig	100.0	100.0
Test pressure	psig	130.0	130.0
Design temperature	°F	200.0	
Overall length x width x height	in	134 x 45 x 126	
Liquid volume	ft ³	59.9	26.0
Net weight, empty / operating	lb	13775 / 19184	

Performance is conditioned on the accuracy of customer's data and customer's ability to supply equipment and products in conformity therewith.

26391



Alfa Laval Richmond VA

100 PSI AT 200 F

-20 F AT 100 PSI

30110-68349 Year 2007

Model WIDEGAP350S-FG

Area 3116.00/SQ.FT.

1253MM/W/154 0.60MM PLTS

649058

P.O. 4500129967

TAG FERMENTER COOLER 2

TAG E-3105

866-ALFALAVAL WWW.ALFALAVAL.COM



WARNING

READ INSTRUCTION MANUAL
BEFORE INSTALLATION,
OPERATION AND MAINTENANCE
TO AVOID INJURIES
OR DAMAGE.